

Product overview

GPS + WIFI + LBS positioning
Real-time location query
Geo-fence alert
Tamper alert
Cover remove alert
Strong magnet mount
10,000mAh battery powered
IP65 dust and water resistant

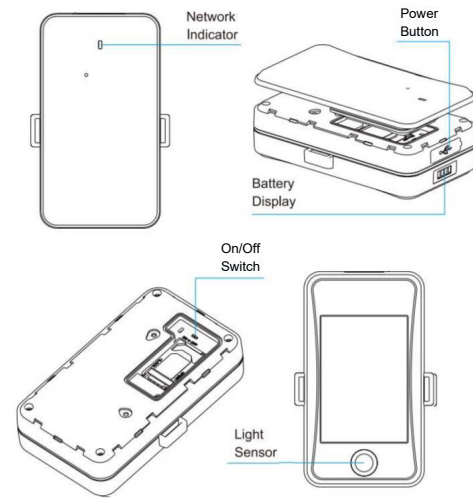

Specification

GSM	B5(850MHz)/B2(1900 MHz) B8(900MHz)/B3(1800MHz)
LTE	B1 /B2/B3/B4/B5/B8/B12/B13/B18/ B19/B20/B26/B28/B66
TTFF (open sky)	Avg. Cold start: <40sec; Avg. Hot start: <1sec
Location accuracy	<10m
Dimension	109X61 X 30.5mm
Weight	297g
Battery	10000 mAh, 3.7V Li-Polymer battery
Operating Temperature	-20°C to +70°C
Transmit Protocol	TCP

Product setup

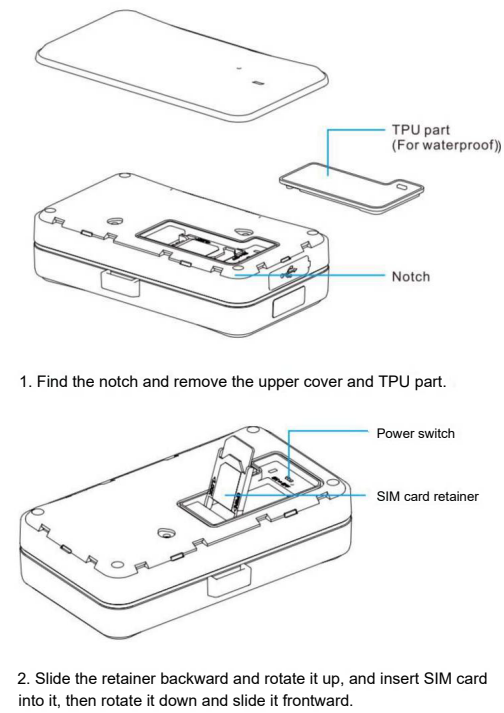

1. Find the notch and remove the upper cover and TPU part.

2. Slide the retainer backward and rotate it up, and insert SIM card into it, then rotate it down and slide it forward.

Common commands

Command	Description	Remark
APN	Set APN	In most countries, APN could be automatically adapted to local mobile operators. If not, please confirm your APN and do the setting. APN, ApnName# or APN, ApnName,User,Password# Auto set APN will be turned off when set APN manually. APN# Query current APN
SERVER	Platform server setting	If you need to use your own server, make sure you have changed the server setting. SERVER, _1, domain name, port# SERVER, 0, IP, port# Default: SERVER, 1, GPSDEV, TRACKSOLID.COM, 21102#
MODE	Set working mode	SERVER# Check the current sever settings MODE, A, T1, T2# A=1-2, 1: Tracking mode, 2: Ultra power saving mode; Default: 1 When A=1, T1: Report interval of GPS data in moving status, range: 10-3600 seconds; default: 10 T2: Report interval of GPS data in static status, range: 180-86400 seconds; default: 0 When A=2, T1: start time of the report, format: HH:MM T2: time interval, range: 1-72 hours, default: 24 MODE# Query the current working mode setting

Command	Description	Remark
PWDSW	Set command password	PWDSW, A# A=ON PWDSW, A, B# A=Numbers and alphabets, 1-19 digits; Default: 666666 B=OFF When PWDSW is ON, all the command has to send with the password as the first parameter, e.g.: MODE, 666666, 1, 30, 30# PWDSW# Query current password setting
PASSWORD	Modify command password	PASSWORD, A, B# A=Old password, Default: 666666 B=New password
PWRLIMIT	Power OFF limitation	PWRLIMIT, ON# X=ON/OFF; ON: Not allow to power off with the device button, OFF: Allow to power off with the device button; PWRLIMIT# Query the current PWRLIMIT setting
RESET	Reboot the device	RESET# The device will reboot in 20 Seconds when receive this command
FACTORY	Recover the settings to factory	FACTORY# Recover all the settings to factory (Except server and APN)

Command	Description	Remark
PARAM	Query device parameters	
GPRSSET	Query platform server and APN Setting	
STATUS	Query status	

Standard parts list

Item	Quantity
JM-LL01 device	1
Adhesive magnetic board	1
Charging cable	1

JM-LL01

LTECATM1 &NB2 ASSET TERMINAL

User Manual

V1.1