

## Main feature:

- Network: GSM 850/900/1800/1900MHz, GPRS Class 12
- Positioning modes: GPS + AGPS + Wifi(optional) + LBS
- Tracking System: APP + Web + SMS
- Track + Historical Trace Playback + Geo-Fence
- Voice Recording + Pick up + Sound Call Back
- Support one/two ways SOS communication(GPS SIM card airtime is required), similar like phone talking
- GPS location accuracy: within 10 meters outdoor(may be affected by the environment)
- Wifi location accuracy: within 50 meters(optional for some models)
- LBS location accuracy: above 100 meters
- Working Temperature: -20°C ~ 45°C / Humidity: 5% ~ 95%

## 1、Preparation work

1. Please prepare a nano SIM card which support both GSM and GPRS network, for new SIM card, you can put it in your phone to active it and check the GPRS data function, it's better to set off the **PIN code** of the SIM card

2. Please make sure the SIM card for GPS tracker supports make a regular phone call, so you can use the tracker to make SOS call and realize the pick up function. ( If don't use SOS, a data SIM card with GPRS works too. )

**Remind:** Our GPS tracker is likely to consume about 30MB GPRS data per month.

3. Download and install our free mobile APP in your phone.

## 2、 Power on the GPS and make GPS online

Reference Photo as below:



**Open the GPS tracker cover and Insert the SIM card**

**Power On:** long press power key for 3seconds(3 LED will light up together and then blinking)

**Power off:** long press for 9 seconds (3 LED light up then off )

### **Attention:**

After the GPS tracker power on for 2 minutes with 3 LED blinking, you may meet the following conditions:

**Condition A:** if the yellow LED blinking slow, that means GPS is online, please use APP GPS365/PC web to track it directly.

**Condition B:** if the yellow LED blinking fast, please send SMS

command ""imei#", after the GPS tracker response your phone with correct 15 digits imei #, then please send SMS command to set APN:

**(please put your GPS tracker SIM card in your phone to get the correct APN parameter if necessary)**

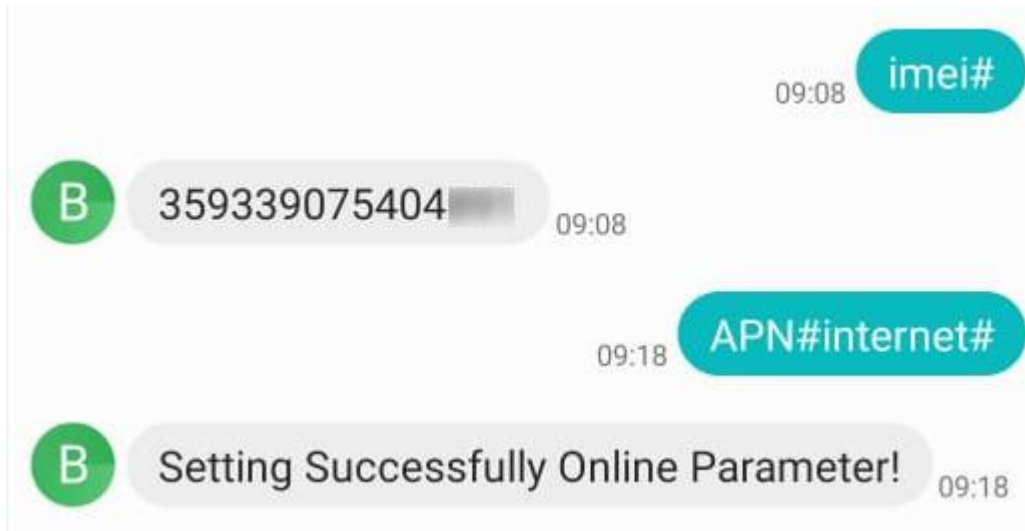

**APN settings: “APN#parameter#account#password#**  
**If your gps sim card don't have account and password,**  
**then send “APN#parameter#” only.**

**Condition C:** if the yellow LED always on(don't blinking), means the SIM card insertion incorrect or invalid SIM card, please take SIM out insert SIM again or change new.

### **3、LED lights**

**Red:** Battery Level LED, fast blinking low battery, slow blinking is normal

**Yellow:** GSM Signal LED, bright error, fast blinking search network, slow blinking connected network

**Blue:** GPS signal LED, fast blinking search GPS satellite, slow blinking connected GPS satellite

### **4、Login the GPS tracker in APP/Web**

Scan the QR code or input the IMEI # to login the APP.

**Login ID: IMEI number ( 15digits )**

**Password: 123456 (or the last 6 digits of imei)**

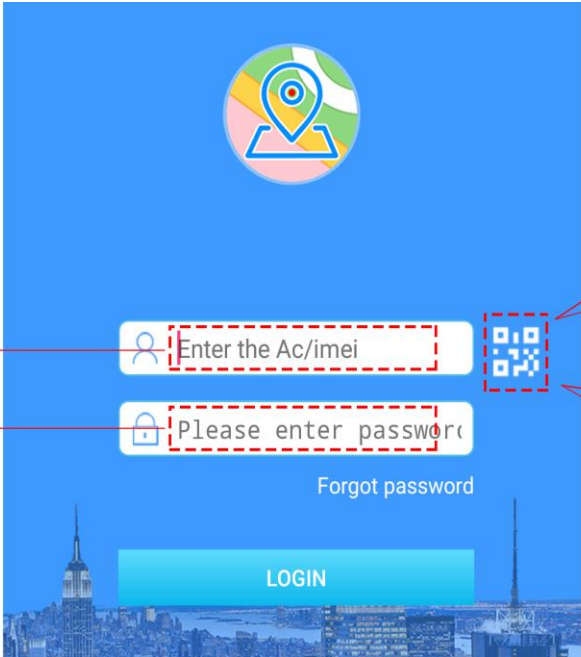

The image shows the login screen of a mobile application. At the top center is a circular icon with a location pin and a signal tower. Below it are two input fields: "Enter the Ac/imei" and "Please enter password". A "Forgot password" link is positioned below the password field. A large blue "LOGIN" button is at the bottom. A QR code icon is located to the right of the input fields. Two callouts are present: one pointing to the QR code icon with the text "Click here to scan QR / Bar code to login", and another pointing to the password field with the text "Input password Default password: 123456".

Input 15 digits IMEI

Input password  
Default password: 123456

Click here to scan QR / Bar code to login

## 5、 Main Functions:

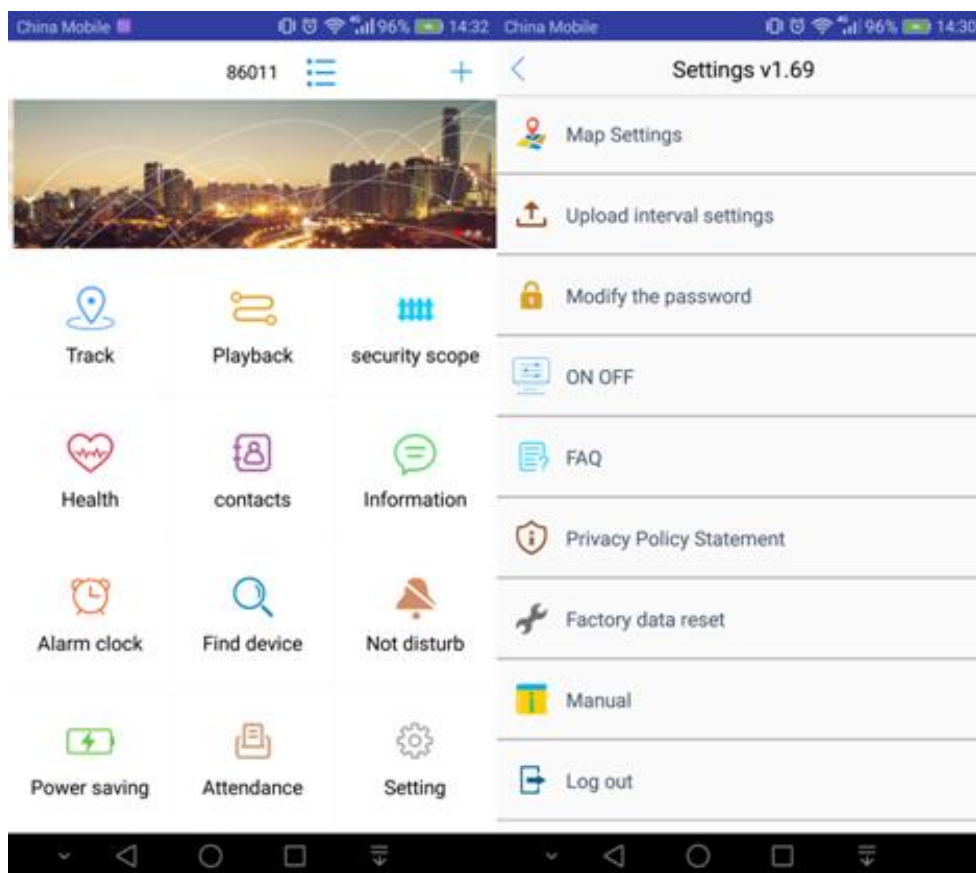

### 5a、 Track

**A: GPS positioning:** when the GPS tracker stay outdoor/good

GPS satellite signal environment, a accurate GPS location

**B: Wifi positioning:** when indoor device will capture the wifi router MAC address and take the MAC address as location.

**C: LBS positioning:** when both GPS and wifi signal are not available for the device, it will give you a general location according to the nearest GSM signal tower around it.

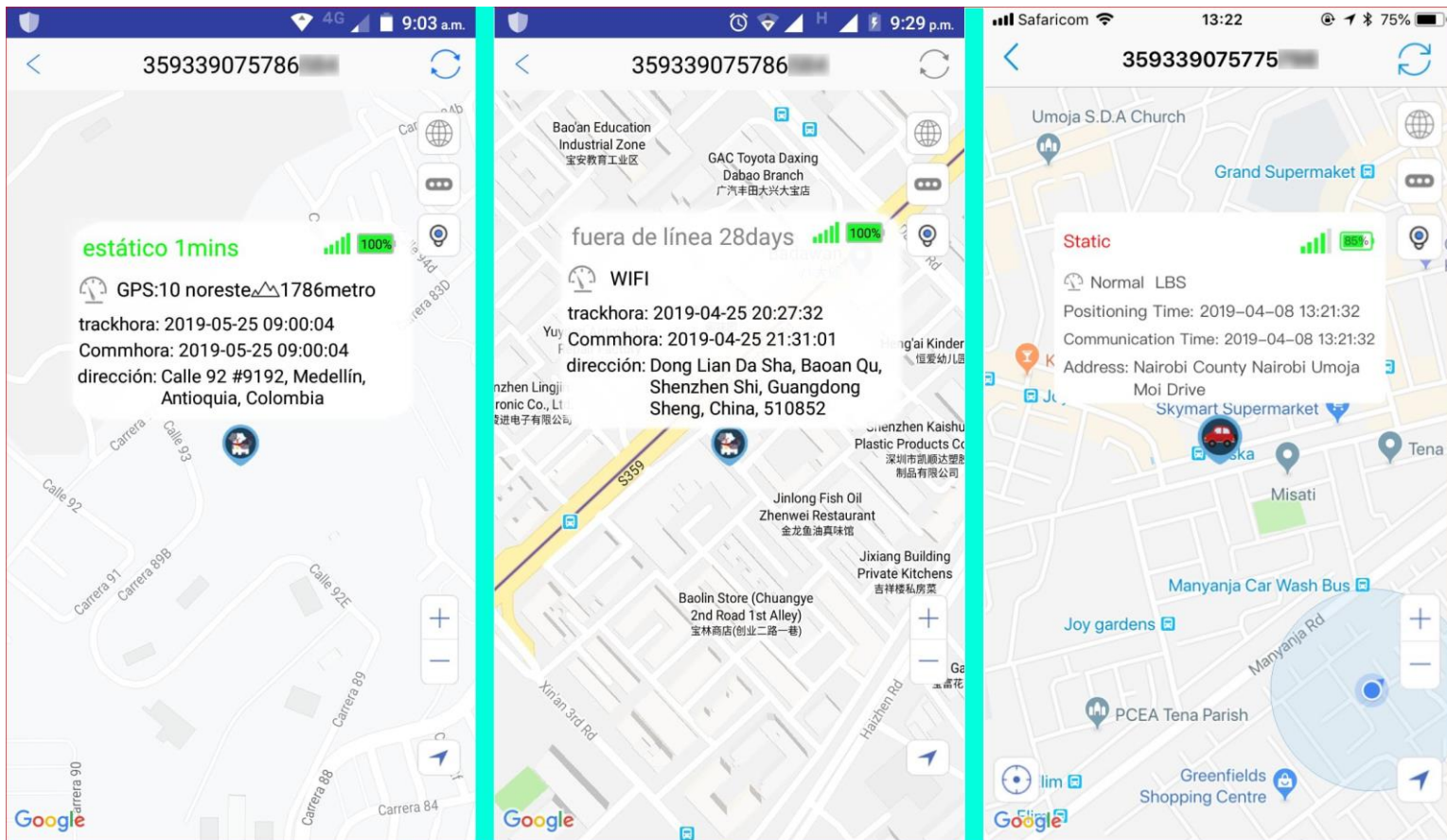

GPS Location

Wifi Location

LBS location

### GPS tracker location accuracy:

GPS: about 10 meters outdoor

Wifi: about 50-500 meters. Attention that wifi location visits telecom carrier's database to get location, in some countries' the carriers' database not open to the public, maybe wifi location can't work, for example Germany.

LBS: above 100 meters. Depends on how many Base Station Towers around the GPS tracker. Normally, if the tracker stay in the city, will be more accurate than that stay in the countryside.

## 5b、 Playback and Geo-fence

### 5b1: Playback:

Please choose the start time and end time and other options in the APP to check the historical trace of your GPS tracker.

### 5b2: Geo-fence:

You can set a security range on the map in your app, once your GPS tracker out of the preset safe range, you will get alarm.

## 5c、 Contact (SOS and pickup)

Set the SOS and pick up tel #(your phone #) in the APP, then long press the tracker power key for 3 seconds till you heard the ringtone “Dingdong”, the tracker will call the SOS phone #. You can also call the tracker directly.

**Pickup = Contacts -- Answer Mode: Auto Answer Call Voice Monitor.** It means: The device will auto pick up your call and no ring, you hear the voice around tracker, tracker side no sound.

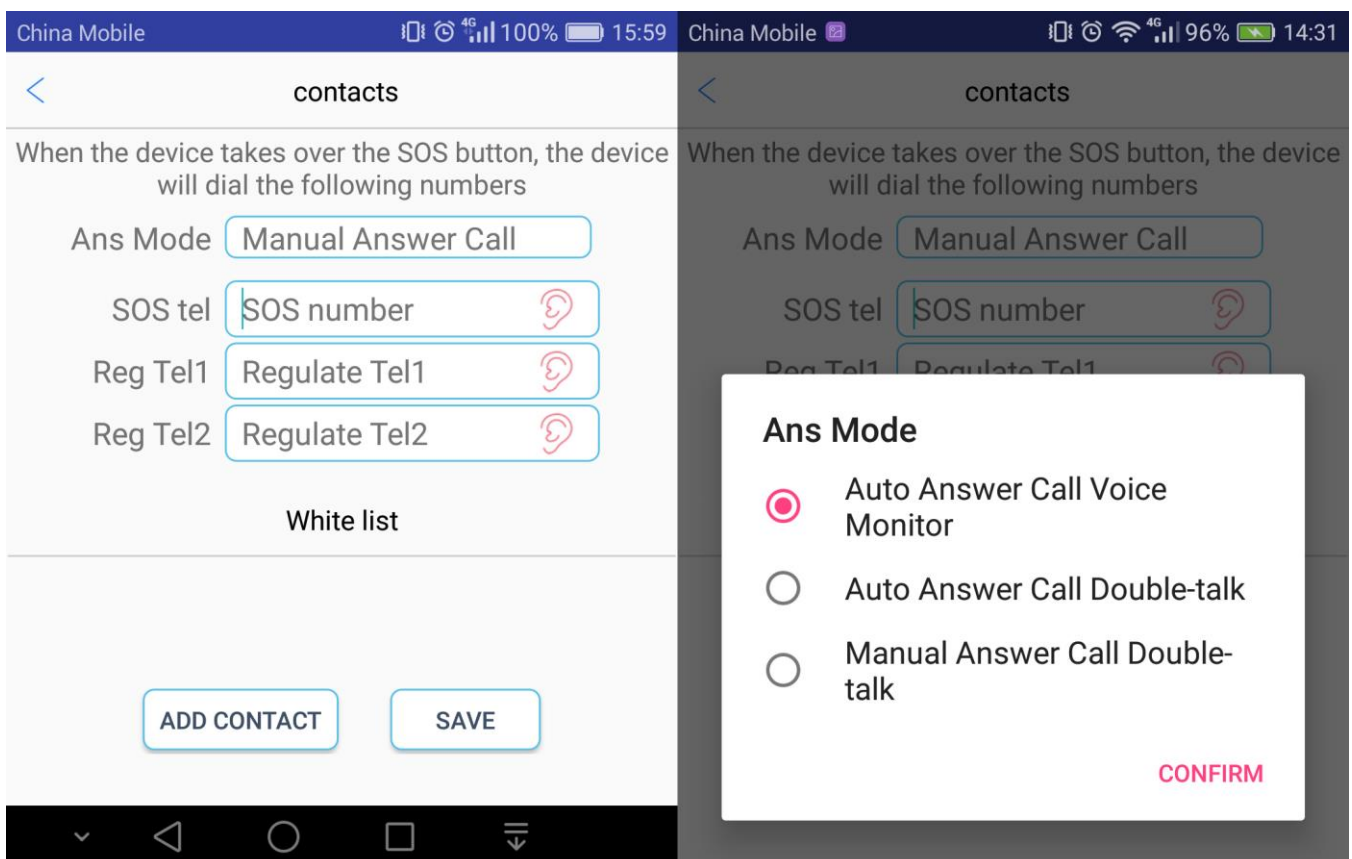

## 5d、 Information (Voice Recorder)

You can click the MIC icon in the App to send voice recording request to the GPS tracker to get voice clips around it, it will send back voice clips soon.

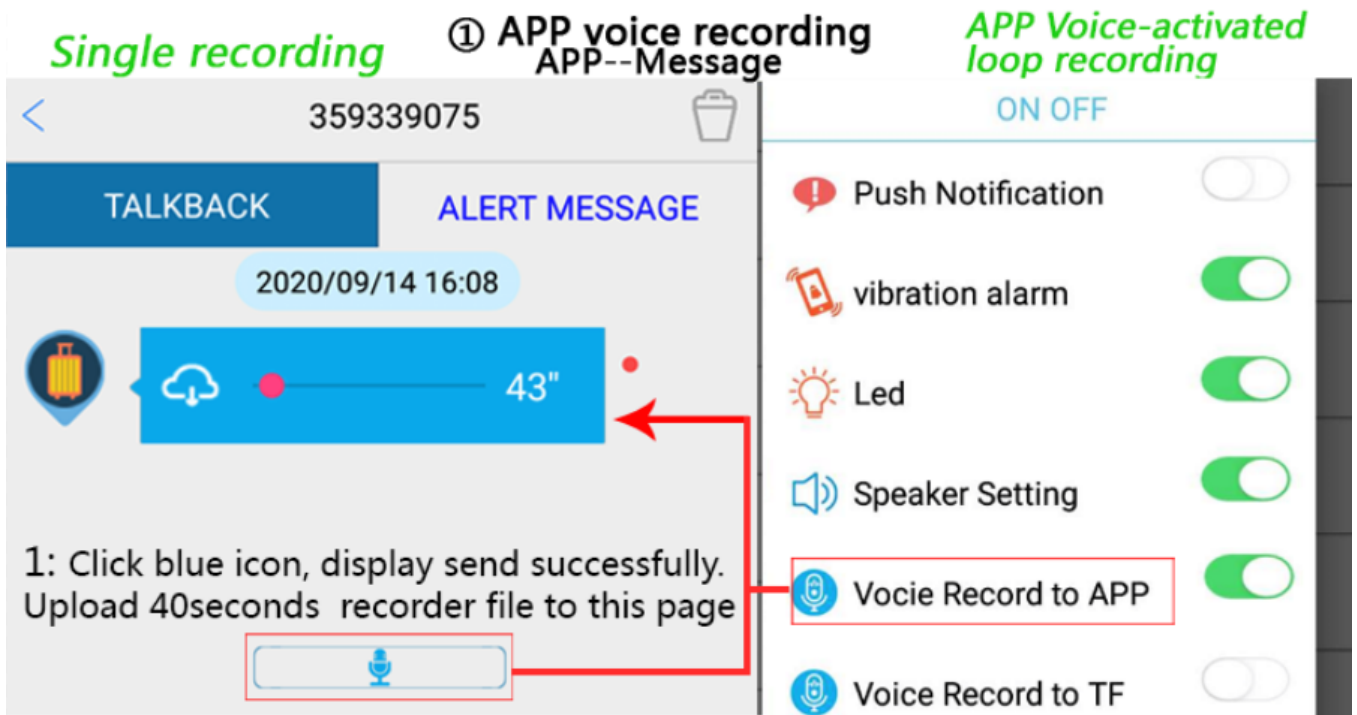

### ② TF card voice recorder (only support with TF card slot)

SMS 111 ( SMS recording 10 minutes pause )

command: 222 ( voice recording 10 minutes pause, auto recording 10minutes again if any voice, every time 10minutes, cancel send SMS 555 )

Read TF card recorder : 1-SMS : 888 , tracker will play the recorder ( requir speaker )  
2-Take TF card out, put into MP3 player or connect PC

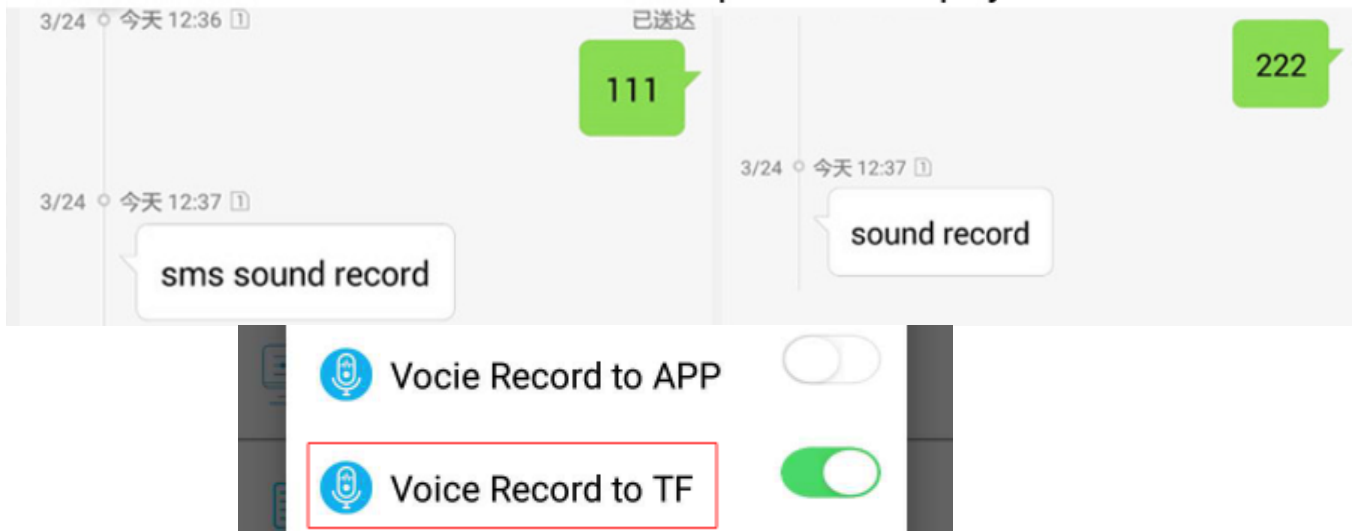

**Attention:** Voice Recorder to APP consumes a lot of sim card's data ,maybe have some delays after you sent the request.

## 5e、 Vibration Alarm

Please enable “Push Notification” and “Vibration alarm” in the setting menu, if someone moved your GPS tracker, the tracker will send vibration alarm push message to your phone timely.

## 5f、 Sound Callback

Send SMS command: “ **000 #number#number#number#** ” , to bind callback phone. if there’s any sound up to 60db, the tracker will call your phone # automatically.

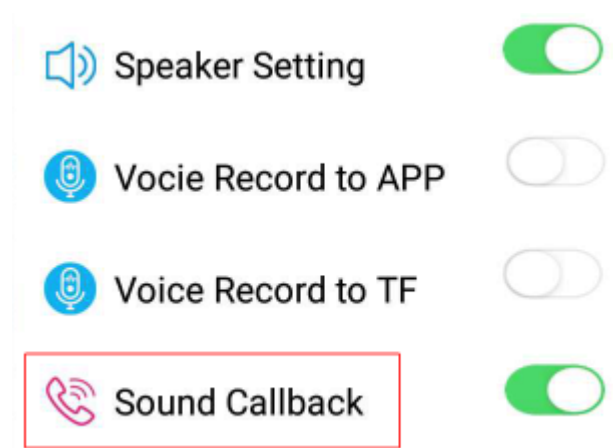

## 6、 Related SMS commands

6.1 Inquire IMEI No.: “ imei# ”

6.2 Restore default password: “ pwrst ”

6.3 Restore to the factory settings: “ 1122 ”

6.4 Set Upload interval:

“time#minute”(minute range 1-120minute);

“md#second”(second range 10-60seconds)

6.5 Turn on/off LED: “ LED#on , LED#off ”

6.6 APN settings: “ APN#parameter#account#password# ”

6.7 Remote Restart: “ sysrst ”



**6.8 Vibration Alarm: “6666#on# / 6666#off#”**

**6.9 Heartbeat Packet Time: heartbeat#No.#(no.=second)**

**6.10 Turn off GPRS data and location function: link#0#**

**6.11 Turn on GPRS data and location function: link#1#**

**6.12 Control Auto Power On/Off:**

**"pwonoff#day,hour,minute#day,hour,minute"**

(for example: pwonoff#0,0,10#0,2,0 -- mean: the GPS tracker will work for 10 minutes then power off and after 2 hours later it will power on automatically again.)

**6.13 SOS: “SOS#number#number#number#”** :this is for double call talk, device should press button answer the call. You can also set only one number.

## **7、SMS operation**

**000#number#number#number#** (binding three phone # ), this SMS command can be used for sound callback monitor.

**111** ( TF Card Voice Recording 10 minutes pause )

**222** ( TF Card Voice Recording 10 minutes pause, auto recording 10minutes again if any voice )

**333** ( voice-activated dial-back call to binding numbers )

**444** ( delete all contents of memory )

**555** ( turn off all features)

**666** ( vibration alarm SMS to binding number )

**777** ( vibration alarm call to binding numbers )

**888** ( play the memory recording --- this require a speaker )